

VVS



Screw to connect couplings for high pressure applications, Faster interchange.

Screw-on couplings commonly used for applications characterized by very high working pressures and peaks. Heavy duty internal components guarantee the maximum safety and reliability. Faster proprietary profile. Interchangeable with Faster VV series.



Applications



Pressure Drop

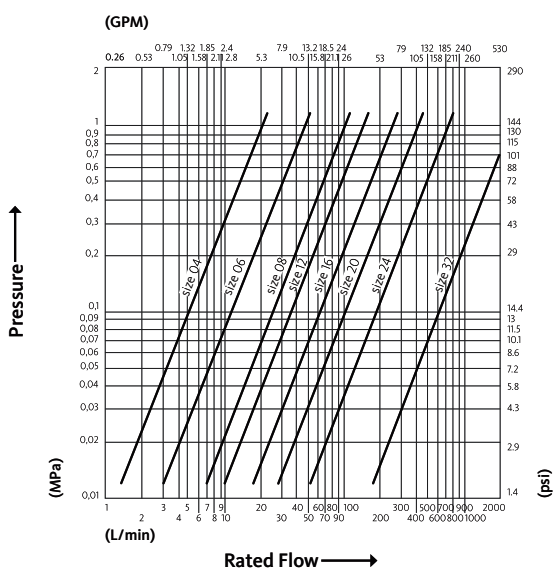

Test performed according to ISO 18869

Technical Specifications

dash	Size mm	inch	Working Pressure (MPa)	Flow Rate (l/min)	Spillage (ml)	Force to Connect (N)	Burst pressure (MPa)		
							Male	Female	Male + Female
04	6.3	1/4"	80	8	0.4	0	240	240	250
06	10	3/8"	80	18	0.8	0	340	350	240
08	12.5	1/2"	70	40	1.3	0	210	210	210
12	20	3/4"	70	55	1.8	0	240	210	230
16	25	1"	63	100	8	0	190	240	190
20	31.5	1-1/4"	60	140	15	0	180	180	200
24	37.5	1-1/2"	40	300	38	0	120	150	150
32	50	2"	35	1000	46	0	130	130	105

Material	Steel
Seals	NBR
Working temperatures	- 25 °C to + 125 °C
Surface treatment	MATE 500 (CrIII)
Series Interchange	FASTER

Valve Type	Poppet
Connection	Screw to Connect
Disconnection	Unscrew to Disconnect
Connection Under Pressure	Not Allowed



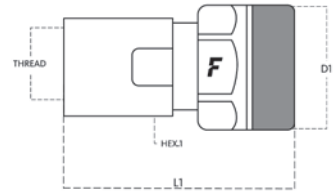

Size		Thread details			FEMALE						
mm	inch	Thread Type	Standard	Thread	Part Number	L (L1 + Thread)		D1		HEX1	
						mm	inch	mm	inch	mm	inch
6.3	1/4"	F NPTF	ANSI B1.20.3	NPTF 1/4" FEMALE	VVS 14 NPT F	68	2.68	30	1.18	22	0.87
6.3	1/4"	F BSPP	ISO 1179-1	BSPP 1/4" FEMALE	VVS 14 GAS F	68	2.68	30	1.18	22	0.87
10	3/8"	F NPTF	ANSI B1.20.3	NPTF 3/8" FEMALE	VVS 38 NPT F	76	2.99	40	1.57	30	1.18
10	3/8"	F BSPP	ISO 1179-1	BSPP 3/8" FEMALE	VVS 38 GAS F	76	2.99	40	1.57	30	1.18
12.5	1/2"	F NPTF	ANSI B1.20.3	NPTF 1/2" FEMALE	VVS 12 NPT F	87	3.43	45	1.77	34	1.34
12.5	1/2"	F BSPP	ISO 1179-1	BSPP 1/2" FEMALE	VVS 12 GAS F	87	3.43	45	1.77	34	1.34
20	3/4"	F NPTF	ANSI B1.20.3	NPTF 3/4" FEMALE	VVS 34 NPT F	106	4.17	55	2.17	41	1.61
20	3/4"	F BSPP	ISO 1179-1	BSPP 3/4" FEMALE	VVS 34 GAS F	106	4.17	55	2.17	41	1.61
25	1"	F NPTF	ANSI B1.20.3	NPTF 1" FEMALE	VVS 1 NPT F	124	4.88	60	2.36	50	1.97
25	1"	F BSPP	ISO 1179-1	BSPP 1" FEMALE	VVS 1 GAS F	124	4.88	60	2.36	50	1.97
31.5	1-1/4"	F NPTF	ANSI B1.20.3	NPTF 1-1/4" FEMALE	VVS114 NPT F	152	5.98	80	3.15	65	2.56
31.5	1-1/4"	F BSPP	ISO 1179-1	BSPP 1-1/4" FEMALE	VVS114 GAS F	152	5.98	80	3.15	65	2.56
37.5	1-1/2"	F NPTF	ANSI B1.20.3	NPTF 1-1/2" FEMALE	VVS112 NPT F	172	6.77	98	3.86	75	2.95
37.5	1-1/2"	F BSPP	ISO 1179-1	BSPP 1-1/2" FEMALE	VVS112 GAS F	172	6.77	98	3.86	75	2.95
50	2"	F NPTF	ANSI B1.20.3	NPTF 2" FEMALE	VVS 2 NPT F	207	8.15	129	5.08	100	3.94
50	2"	F BSPP	ISO 1179-1	BSPP 2" FEMALE	VVS 2 GAS F	206	8.11	129	5.08	100	3.94

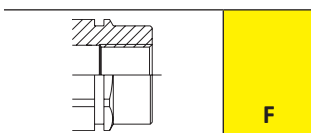

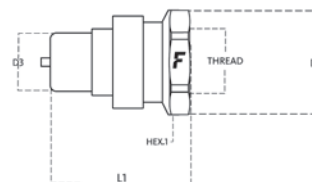

VVS

Size		Thread details			MALE									
mm	inch	Thread Type	Standard	Thread	Part Number	L (L1 + Thread)		D1		D3		HEX1		
						mm	inch	mm	inch	mm	inch	mm	inch	
6.3	1/4"	F NPTF	ANSI B1.20.3	NPTF 1/4" FEMALE	VVS 14 NPT M	48	1.89	28	1.1	14.1	0.56	32	1.26	
6.3	1/4"	F BSPP	ISO 1179-1	BSPP 1/4" FEMALE	VVS 14 GAS M	43	1.69	28	1.1	14.1	0.56	25	0.98	
10	3/8"	F NPTF	ANSI B1.20.3	NPTF 3/8" FEMALE	VVS 38 NPT M	48	1.89	35	1.38	18.9	0.74	30	1.18	
10	3/8"	F BSPP	ISO 1179-1	BSPP 3/8" FEMALE	VVS 38 GAS M	48	1.89	35	1.38	18.9	0.74	30	1.18	
12.5	1/2"	F NPTF	ANSI B1.20.3	NPTF 1/2" FEMALE	VVS 12 NPT M	53	2.09	38	1.5	20.5	0.81	34	1.34	
12.5	1/2"	F BSPP	ISO 1179-1	BSPP 1/2" FEMALE	VVS 12 GAS M	53	2.09	38	1.5	20.5	0.81	34	1.34	
20	3/4"	F NPTF	ANSI B1.20.3	NPTF 3/4" FEMALE	VVS 34 NPT M	63	2.48	50	1.97	27.9	1.1	45	1.77	
20	3/4"	F BSPP	ISO 1179-1	BSPP 3/4" FEMALE	VVS 34 GAS M	63	2.48	50	1.97	27.9	1.1	46	1.81	
25	1"	F NPTF	ANSI B1.20.3	NPTF 1" FEMALE	VVS 1 NPT M	72	2.83	55	2.17	31.3	1.23	50	1.97	
25	1"	F BSPP	ISO 1179-1	BSPP 1" FEMALE	VVS 1 GAS M	72	2.83	55	2.17	31.3	1.23	50	1.97	
31.5	1-1/4"	F NPTF	ANSI B1.20.3	NPTF 1-1/4" FEMALE	VVS114 NPT M	86	3.39	70	2.76	43.9	1.73	65	2.56	
31.5	1-1/4"	F BSPP	ISO 1179-1	BSPP 1-1/4" FEMALE	VVS114 GAS M	86	3.39	70	2.76	43.9	1.73	65	2.56	
37.5	1-1/2"	F NPTF	ANSI B1.20.3	NPTF 1-1/2" FEMALE	VVS112 NPT M	95	3.74	84	3.31	53.4	2.1	80	3.15	
37.5	1-1/2"	F BSPP	ISO 1179-1	BSPP 1-1/2" FEMALE	VVS112 GAS M	95	3.74	84	3.31	53.4	2.1	80	3.15	
50	2"	F NPTF	ANSI B1.20.3	NPTF 2" FEMALE	VVS 2 NPT M	118	4.65	115	4.53	81.9	3.22	110	4.33	
50	2"	F BSPP	ISO 1179-1	BSPP 2" FEMALE	VVS 2 GAS M	118	4.65	115	4.53	81.9	3.22	110	4.33	

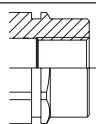

F

VVS Accessories and Spares



Aluminium dust protections

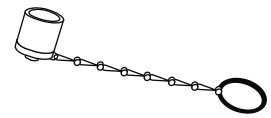
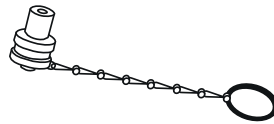

Stainless steel dust protections



Seals Kits