

For switchpointsmm, see label



Ground



1 2 5 6

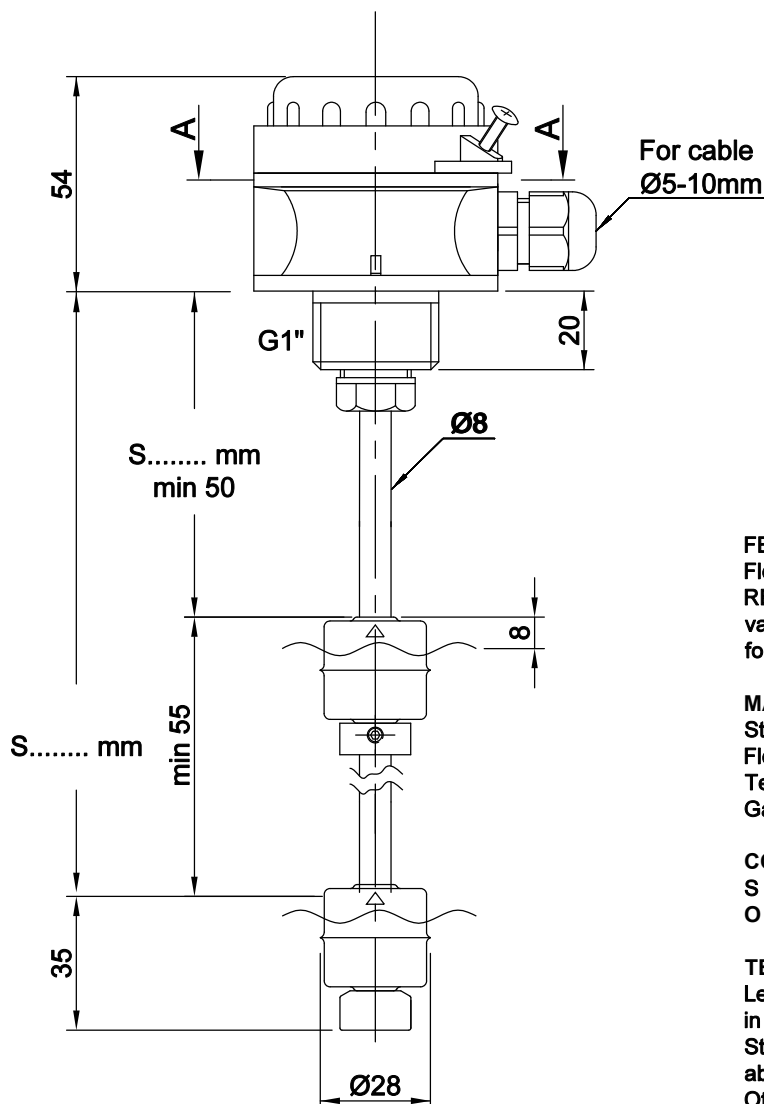
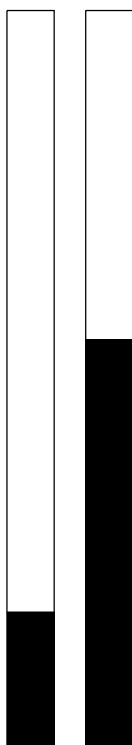

FEATURES

Float liquid level switch with REED-technology to activate pumps or valves via relays or PCs. Recommended for water, chemical and oil fluids.

MATERIALS

Stem : SUS-316
Float : SUS-316, density 0,75
Terminanbox : PA6
Gasket : Nitrile

CONTACT SYMBOLS

S = means NC low, NO going upwards
O = means NO low, NC going upwards

TEMPERATURE SWITCH

Level sensors may be equipped with built in over-temperature protection, if specified. Standard temperature switches open above +70°C and reset at +50°C. Other temperature settings or closing of contacts and tighter tolerances upon request.

PROTECTION DEGREE

Junction box : IP67
Stem : IP68

Temp. media : -20...+100°C
Temp. ambient : -20...+70°C

ELECTRICAL DATA

Contact rating *	70 VA
Supply voltage	3-230 VAC/DC
max current	1,5 A

* = resistive load

Note. Above values are for resistive loads. Mechanical life is 30 millions.

Use series resistor for lamp load, or other suitable protection for inductive loads if the rating is higher than 1/10 of the values above.

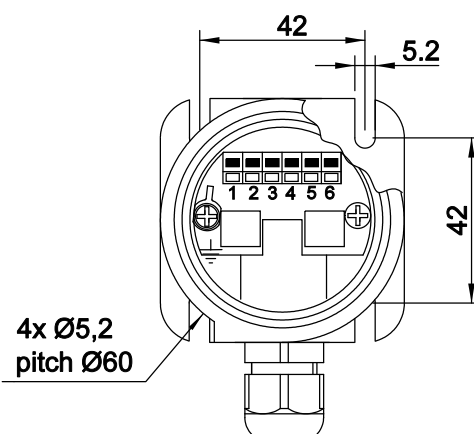

Section A-A