



**Bernstein**

Bernstein AG  
Postfach 1164  
D-32437 Porta Westfalica

# Technical data sheet

ENK-SU1 Ri w

618.1167.154

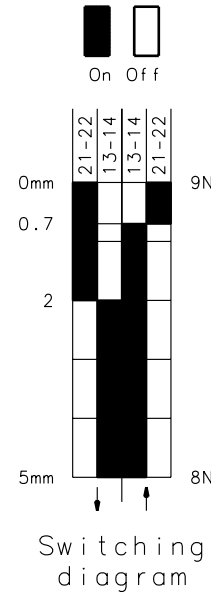
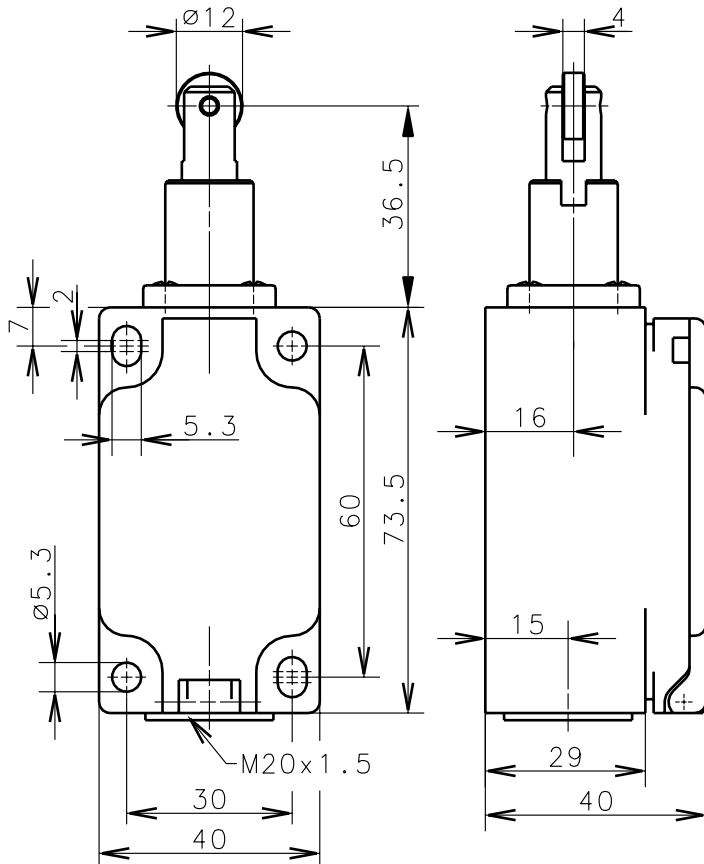

Tolerance: operating point  $\pm 0.25\text{mm}$ ; actuating force  $\pm 10\%$

### Mechanical features

Enclosure:	Thermoplast, glass fibre reinforced
Cover:	Thermoplast, glass fibre reinforced
Actuator:	Ni-Roller

Ambient air temperature:	-30°C up to +80°C
Contact type:	1 NC-contact, 1 NO-contact

Mechanical life:	$10 \times 10^6$ switch operations
Switch frequency:	max. 100/min
Mounting:	4 x M5
Connection type:	4 screw connectors (M3,5)
Conductor cross-section:	single core 0.5-1.5mm <sup>2</sup> / Litz wire with connector sleeve 0.5-1.5mm <sup>2</sup>
Cable entry size:	1 x M20x1.5
Weight:	approx. 0,16kg

### Electrical features

Rated insulation voltage:	$U_i = 220 \text{ V AC}$
Conventional thermal current:	$I_{the} = 10 \text{ A}$
Max. inrush current:	according to IEC 60947-5-1, AC 15, A300
Utilization categorie:	AC 15, A300, $U_e/I_e$ 240V/3A
Standards:	according to EN 60947-1; EN 60947-5-1
Protection class (IP-Code):	IP65 according to EN 60529; DIN VDE 0470 T1
Short-circuit protection:	Fuse 2A gL/gG, IEC/EN 60947-5-1

### Approach possibilities

By loosening the 4 screws the Actuation Assembly can be rotated in 90 degree increments such that 2 Actuation directions are possible. The Actuation Assembly is to be again fastened to the housing using the 4 screws.

### Remarks

The moving parts should be oiled periodically  
The rated protection class (IP-Code) is valid only at closed cover and when using an at least equivalent cable gland.